



# Installation Guide

## ELD Canada

# Table of Contents

OVERVIEW _____	1
WHAT'S IN THE BOX? _____	1
REVISION HISTORY _____	2
INSTALLATION-JBUS and ELD _____	2
SETUP- AZUGA FLEET TRACKING _____	6



# Overview

We appreciate your interest in choosing Azuga as your fleet tracking partner. This document provides instructions for new users on

- How to install JBus and ELD into your vehicle.
- How to set up the device in the Azuga fleet applications.

Before installation, kindly note the device serial number (Printed on the Azuga device). You will need this information at a later time to set up your device in the Azuga App.

## What's in the box?

JBus device	 <p>JBUS device is shipped with the standard cables attached.</p>
ELD	
Geometris Y-cable	

## Revision History

Date	Revision	Comment
February 2023	Version 1	Initial Version

## Installation - JBus and ELD

Based on the type of port, a JBus and ELD device can be installed through any of the following

- 16 Pin Port, 6 Pin port or 9 Pin Port

### 16-Pin Port:

Locate the Vehicle's diagnostic port, typically it can be found below the steering wheel. Follow the below steps to install JBus

*Fig:1 JBus 16 Pin Port*



*Fig:2 JBus 16 Pin Port covered*

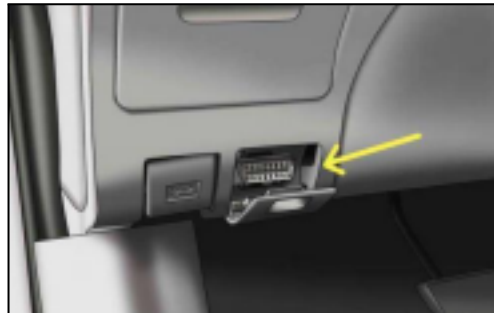

1. Switch off the vehicle or the unit on which the installation is performed.
2. Plugin the female end of the Geometris Y-cable into the diagnostic port.

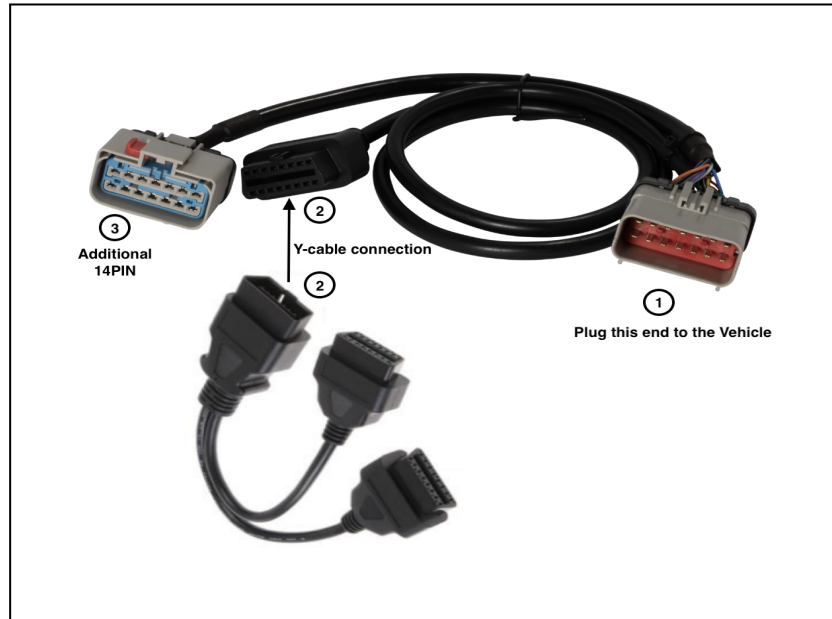

3. Connect Azuga Y-cable to the 16Pin port of the Geometrics Cable.
4. Connect the Azuga device to one end of the Y cable and connect the ELD device to the secondary end of the Y cable.

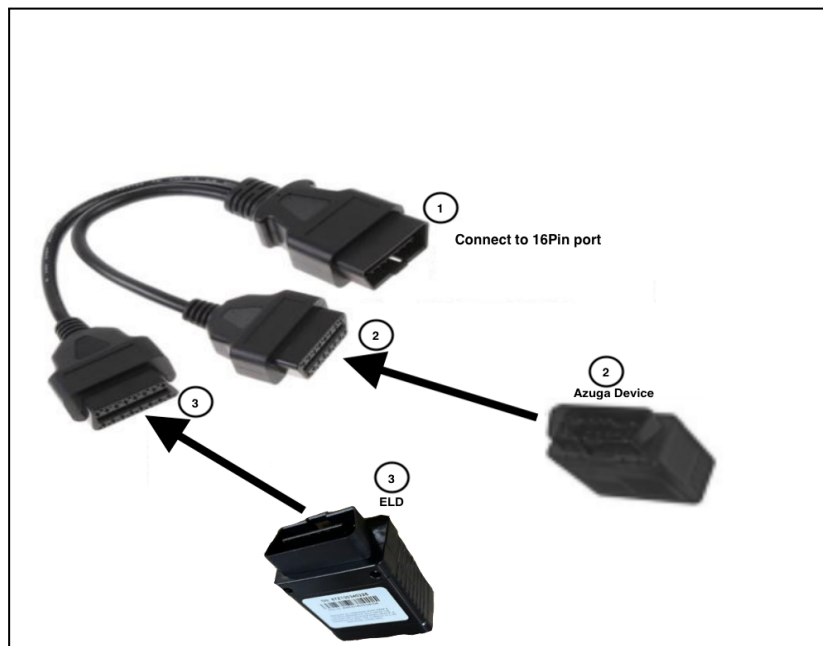

5. Setup is initialized and power is received once the LEDs on the Azuga device start flashing.
6. Ensure the Green LED lasts for 5 seconds, which indicates the device is ready to use.

**Note:** If the Red LED blinks, the installation fails, remove the device and repeat the same steps.  
For more information reach out to [customercare@azuga.com](mailto:customercare@azuga.com)

## 6 Pin Port:

1. Plug the cable into the vehicle diagnostic port as shown below.

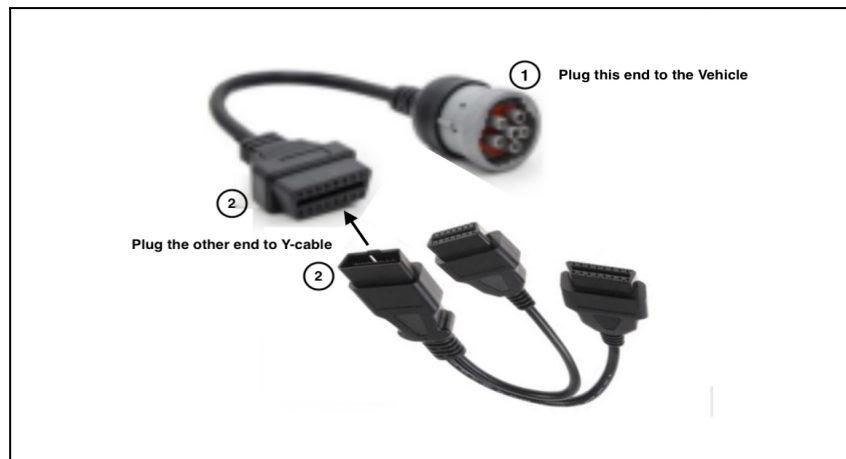

2. Plug in the female end of the Y-cable into the other end.
3. Connect the Azuga device to one end of the Y cable and connect the ELD device to the secondary end of the Y cable.

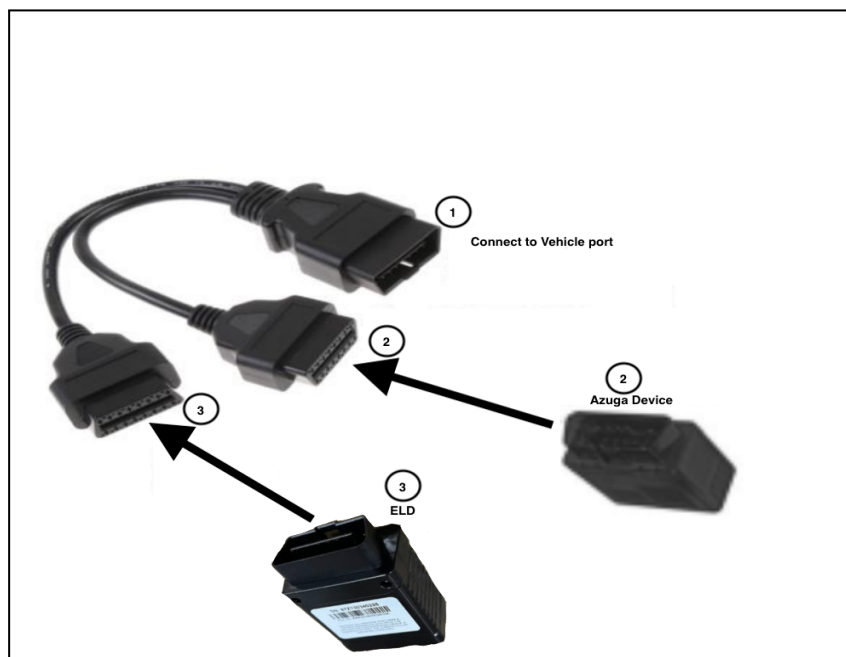

4. Setup is initialized and power is received once the LEDs on the Azuga device start flashing.
5. Ensure the Green LED lasts for 5 seconds, which indicates the device is ready to use.

**Note:** If the Red LED blinks, the installation fails, remove the device and repeat the same steps.  
For more information reach out to [customercare@azuga.com](mailto:customercare@azuga.com)

## 9 Pin Port

1. Plug in the female end of the Jbus Y-cable into the diagnostic Port.
2. Connect the OBDII Y cable to one end of the Jbus Y cable and use another end for the occupied device.

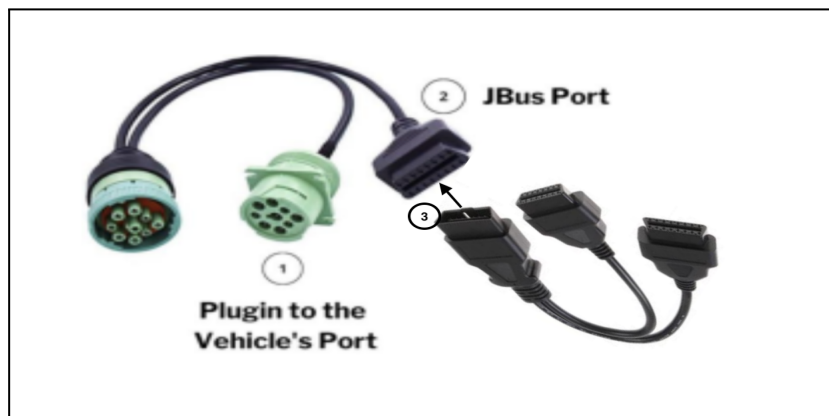

3. Connect the Azuga and ELD devices to Two ends of the Y cable.

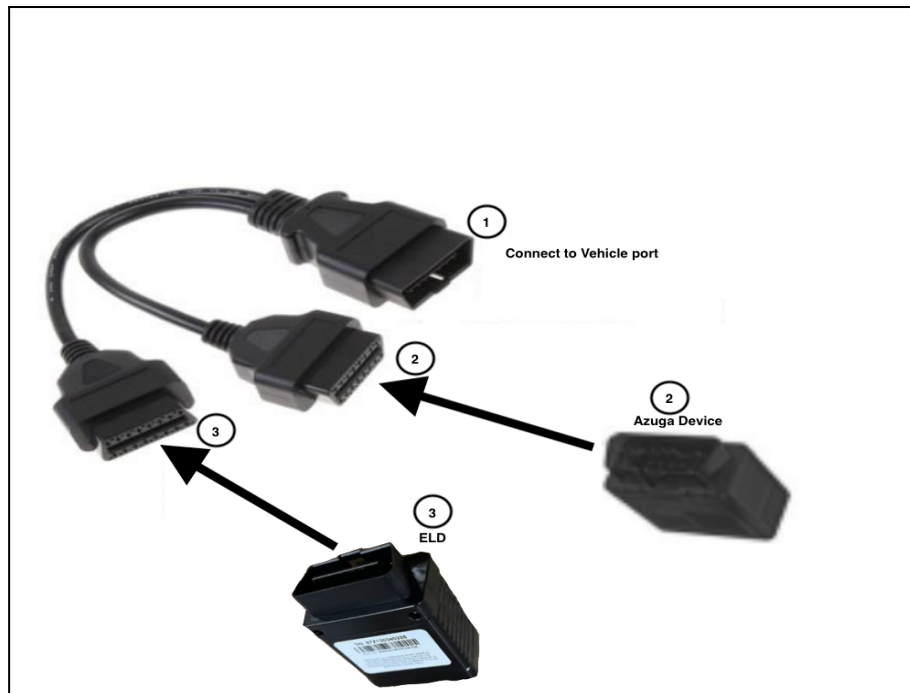

4. Setup is initialized and power is received once the LEDs on the Azuga device starts flashing.
5. Ensure the Green LED lasts for 5 seconds, which indicates the device is ready to use.

**Note:** If the Red LED blinks, the installation is failed, remove the device and repeat the same steps.  
If the problem persists kindly reach out to [customercare@azuga.com](mailto:customercare@azuga.com)

## Setup- Azuga Fleet Tracking

The installed JBus device needs to be set up for fleet tracking. Below are the 2 methods to set up the device

- Setup from Fleet Mobile App
- Setup from Fleet Web App

**Important:** If Login credentials are not yet received, reach out to [customercare@azuga.com](mailto:customercare@azuga.com)  
It is recommended to change the password when you log in for the first time. Refer FAQs section in the Azuga web application for more information.



## Azuga Fleet Mobile App

1. Login into Azuga Fleet Mobile App and navigate to UTILITIES>>INSTALLATION.

**Note:** If the Installation feature is not available Kindly reach out to [customercare@azuga.com](mailto:customercare@azuga.com)

2. Tap Installation and Select the JBus Plug'n'Play option.

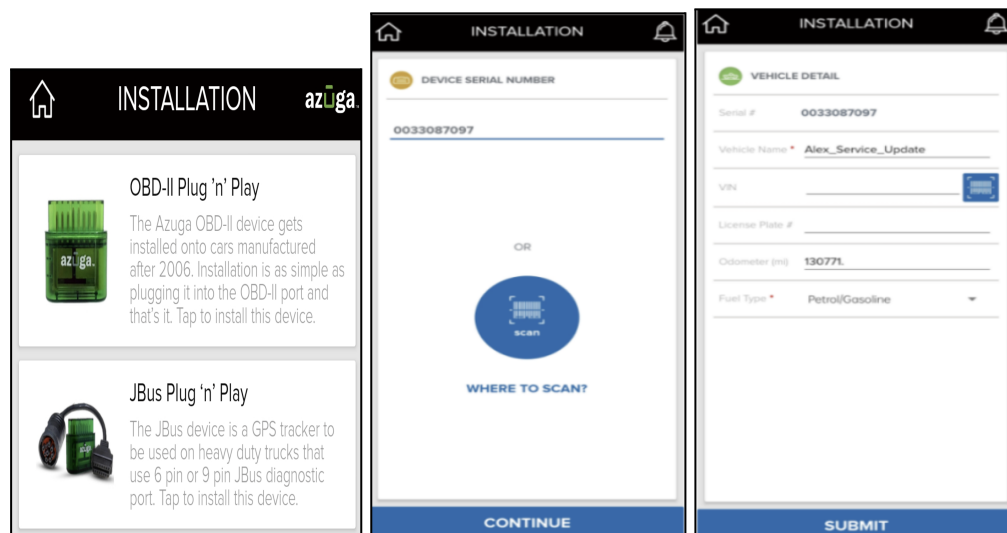

3. Device serial can be fed by any of the following methods
  - I. Tap the Where to Scan button and scan the barcode printed on the Azuga device.
  - II. Type the serial number manually.
4. Click the Continue button, verify the details shown, and Click Submit.

## Azuga Fleet Web

1. Open **Azuga Fleet Web Login** and enter your Login Credentials.
2. Devices and vehicles are already created in the portal by Azuga. Vehicle names and device serial numbers are the same by default.

**Note:** Vehicles(created by default) can be renamed as per your requirements.

3. Click the ADMIN tab and select Vehicles.

4. Click the Pencil icon to edit/add/remove the details for the selected vehicle.

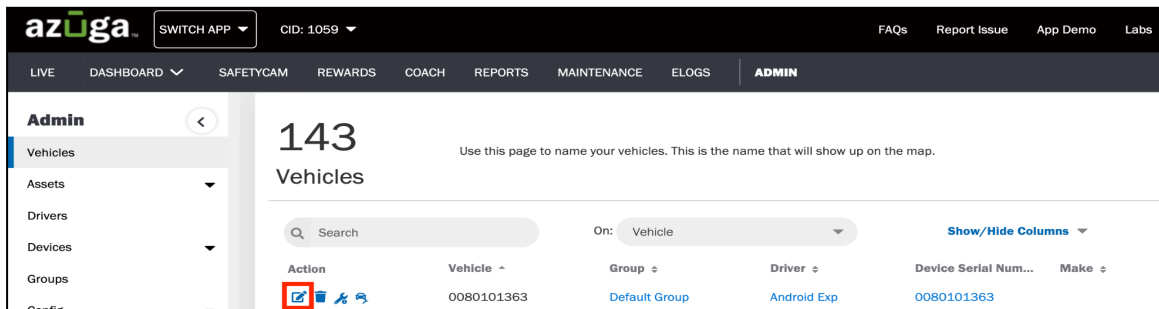

5. Fill in the mandatory(\*) fields and click the Update Vehicle button.

The screenshot shows the 'Update Vehicle' form. It has a title bar with 'Update Vehicle' and a close button. The form is divided into several sections with labels and input fields. The fields are: Vehicle Name (with a red asterisk), VIN, Emission, Group (with a dropdown), Initial Odometer, Current Odometer, Service Due (with a calendar icon), Device (with a dropdown), Initial Engine Hours, Current Engine Hours, Road Tax, Make (with a dropdown), Asset Number, Permit, Model (with a dropdown), Ownership (with a dropdown), Fire Extinguisher, Year (with a dropdown), Vehicle Type (with a dropdown), External ID, and Safety Tags. The 'Submit' button at the bottom is highlighted with a red box.

**Note:** Repeat the steps for the remaining vehicles and ensure the vehicle names are unique.  
Reach out to [customercare@azuga.com](mailto:customercare@azuga.com) for additional support.

## Actual Images of connectors



9 PIN Square connector



9 PIN "D" Style connector



6 PIN connector



14 to 16 PIN connector